

VISINA PARKIRALIŠTA cca 245 cm

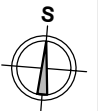
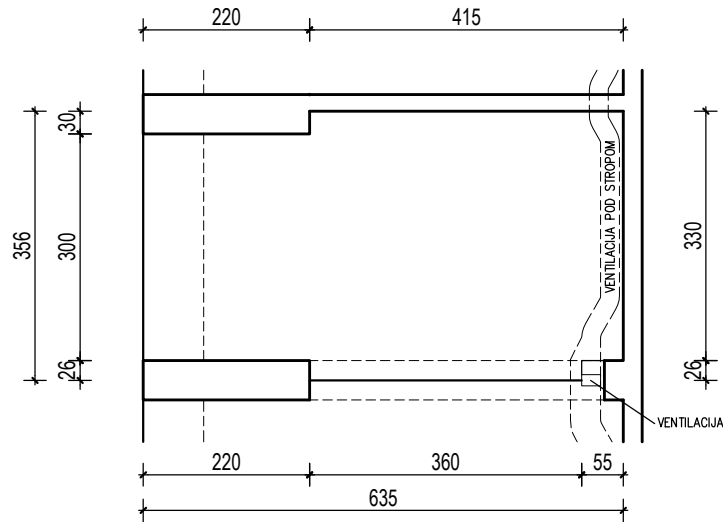

MJ 1:100

PODRUM -2 , DIO N, PARKIRALIŠTE N-67

P= 21,23 m²

NAPOMENA: PO POTREBI TREBA OMOGUĆITI PRISTUP ZAJEDNIČKIM INSTALACIJAMA

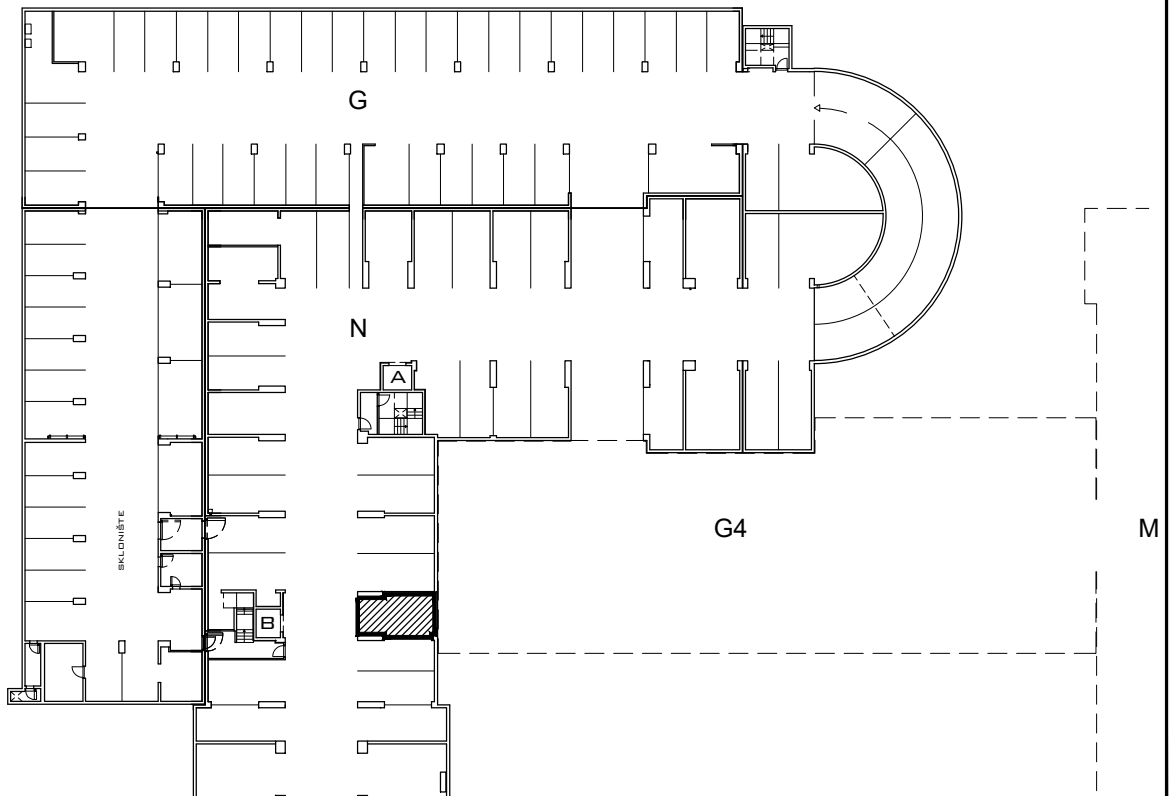

POLOŽAJ PARKIRALIŠTA U GARAŽI NA ETAŽI PODRUM -2