

VISINA PARKIRALIŠTA cca 370 cm

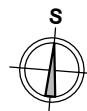
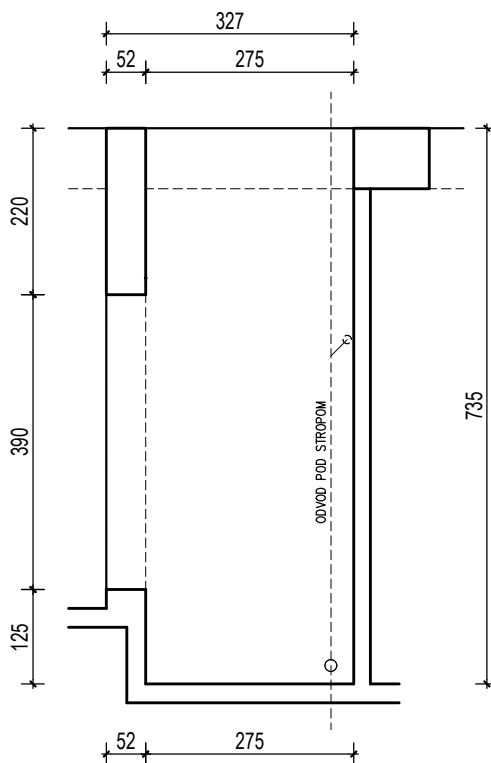

MJ 1:100

PODRUM -1 , DIO N, PARKIRALIŠTE N-37

P= 22,24 m²

NAPOMENA: PO POTREBI TREBA OMOGUĆITI PRISTUP ZAJEDNIČKIM INSTALACIJAMA

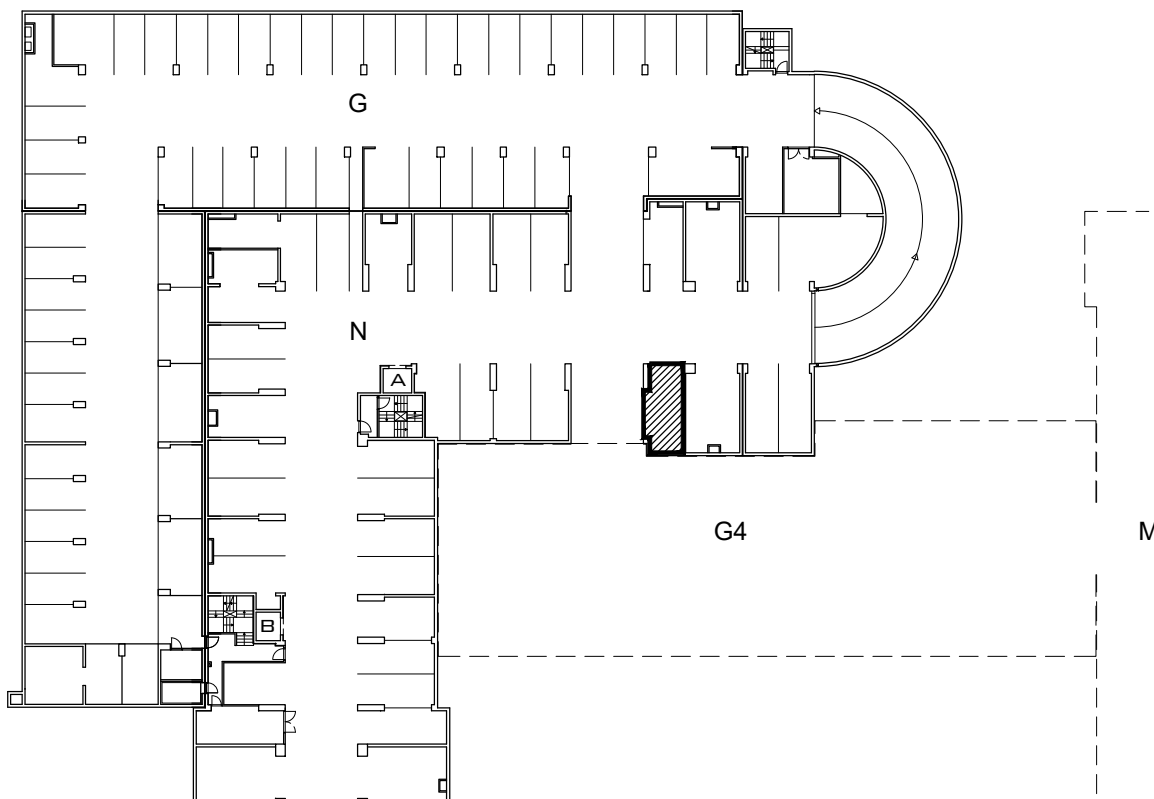

POLOŽAJ PARKIRALIŠTA U GARAŽI NA ETAŽI PODRUM -1