

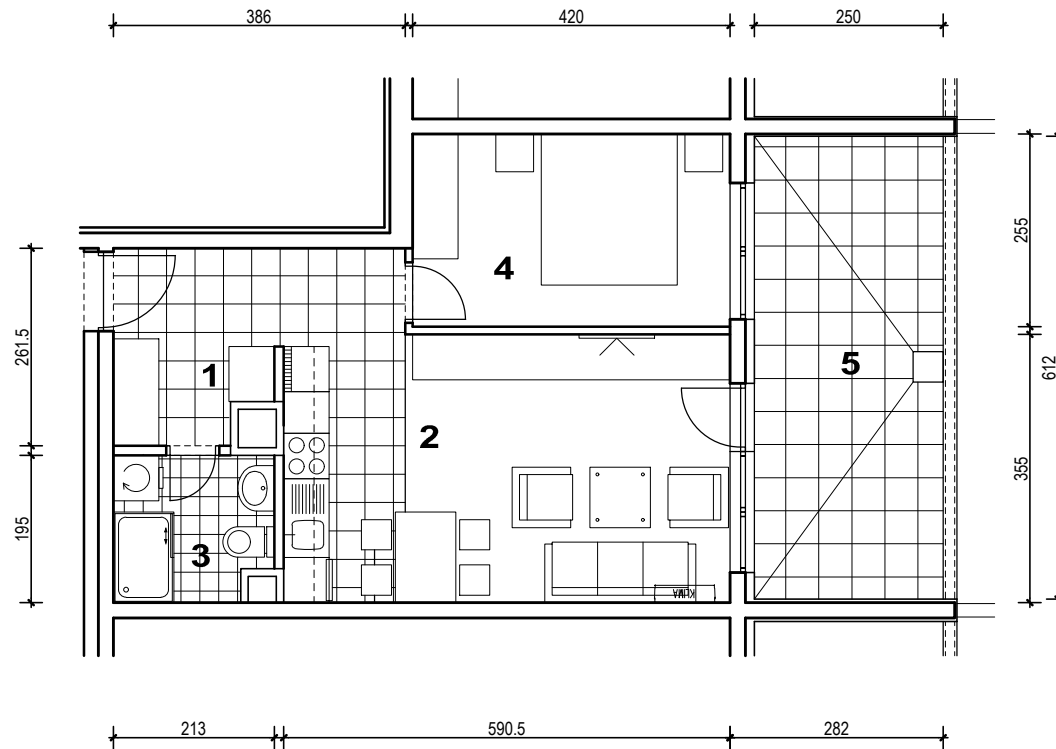

POLOŽAJ U NASELJU

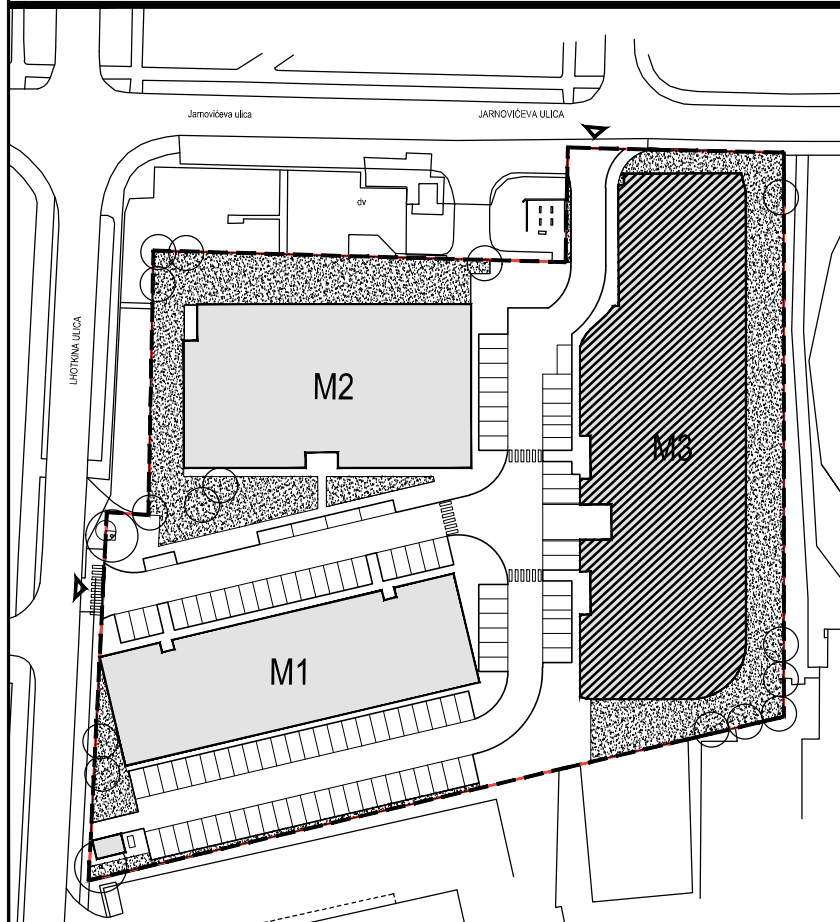

SITUACIJA



MJ 1:100



POLOŽAJ STANA U ZGRADI

PRESJEK

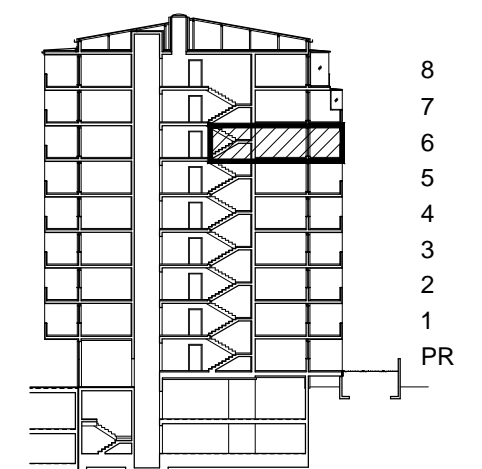
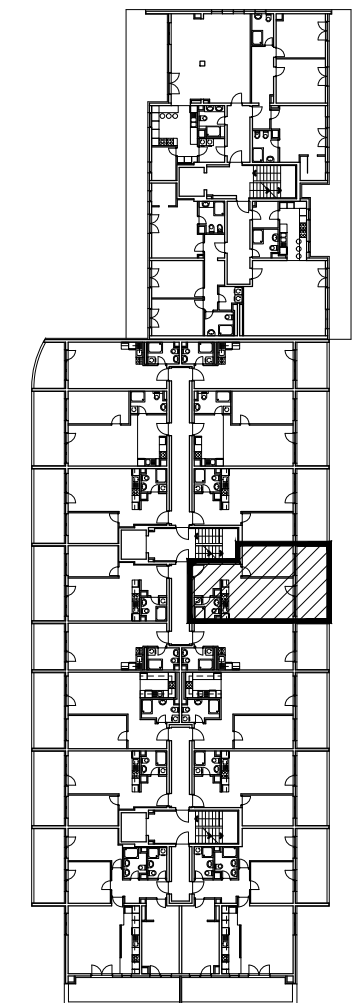

POLOŽAJ STANA U ZGRADI

STAN M3B-66 - dvosobni

6. KAT

1. ULAZ		7.22	m ²
2. KUHINJA + DNEVNI BORAVAK		20.96	m ²
3. KUPAONICA		3.92	m ²
4. SOBA		10.71	m ²
5. LOGGIA	0.75x15.30	11.48	m ²
SVEUKUPNO		54.29	m²

STAN M3B-66 P= 54.29 m²