

Visina parkirališta cca 250 cm

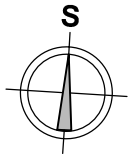
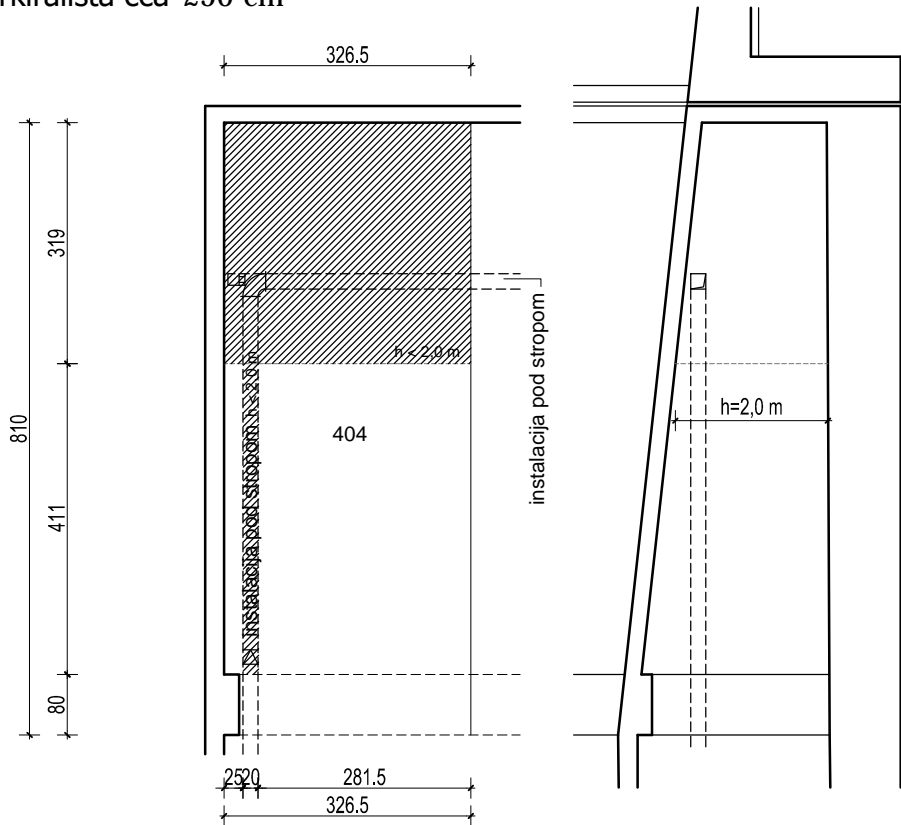

MJ 1:100

PODRUM -3, PARKIRALIŠTE D3-404

$$(11,54 + 1,04) + ((10,41+1,04) * 0,75) = \mathbf{P= 21,17 m^2}$$

NAPOMENA: PRISTUP ZAJEDNIČKIM INSTALACIJAMA POTREBNO JE OMOGUĆITI PO POTREBI

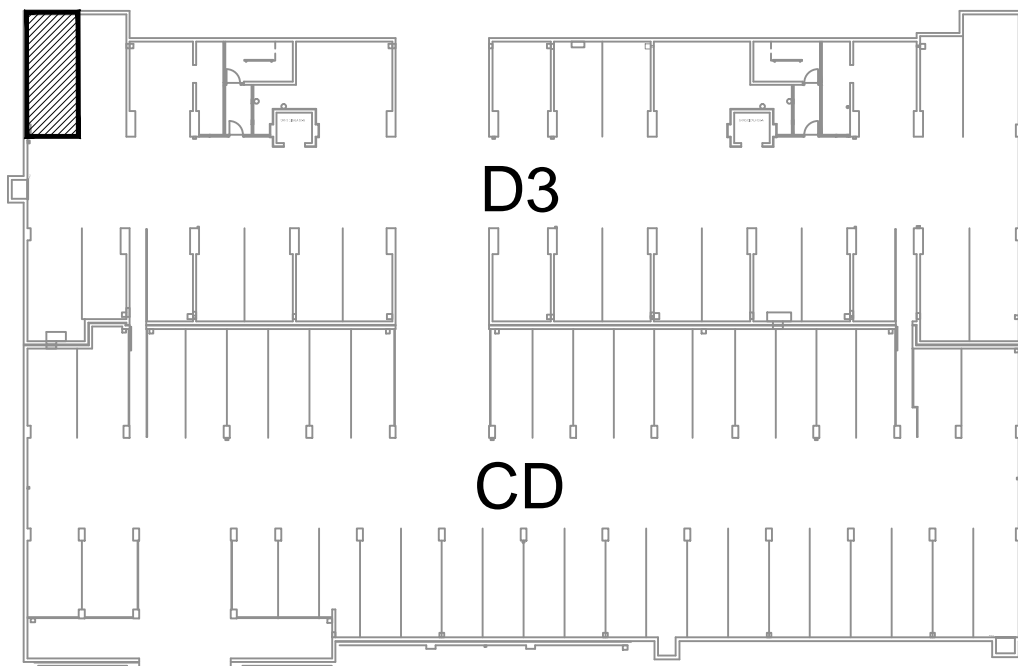

PODRUM -3

POLOŽAJ PARKIRALIŠTA U GARAŽI