

PODZEMNA GARAŽA CD i PODZEMNI DIJELOVI ZGRADE D3 - Lovinčićeva- Ivekovićeve- Ul. B.Perice, Zagreb

Visina parkirališta cca 250 cm

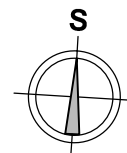
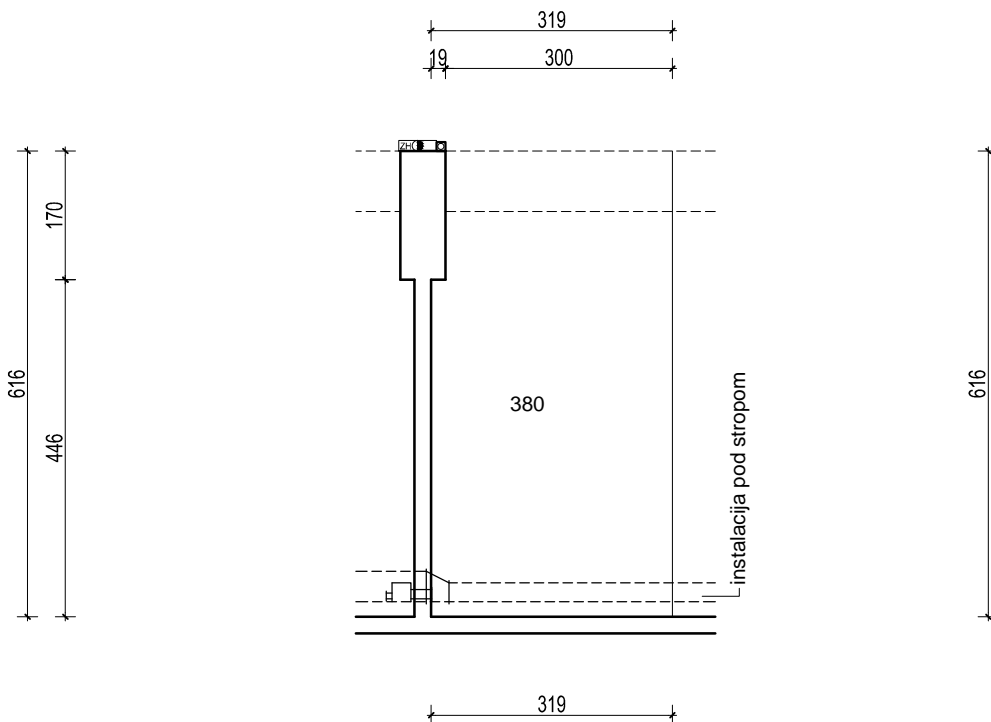

MJ 1:100

PODRUM -3, PARKIRALIŠTE D3- 380

P= 19,33 m²

NAPOMENA: PRISTUP ZAJEDNIČKIM INSTALACIJAMA POTREBNO JE OMOGUĆITI PO POTREBI

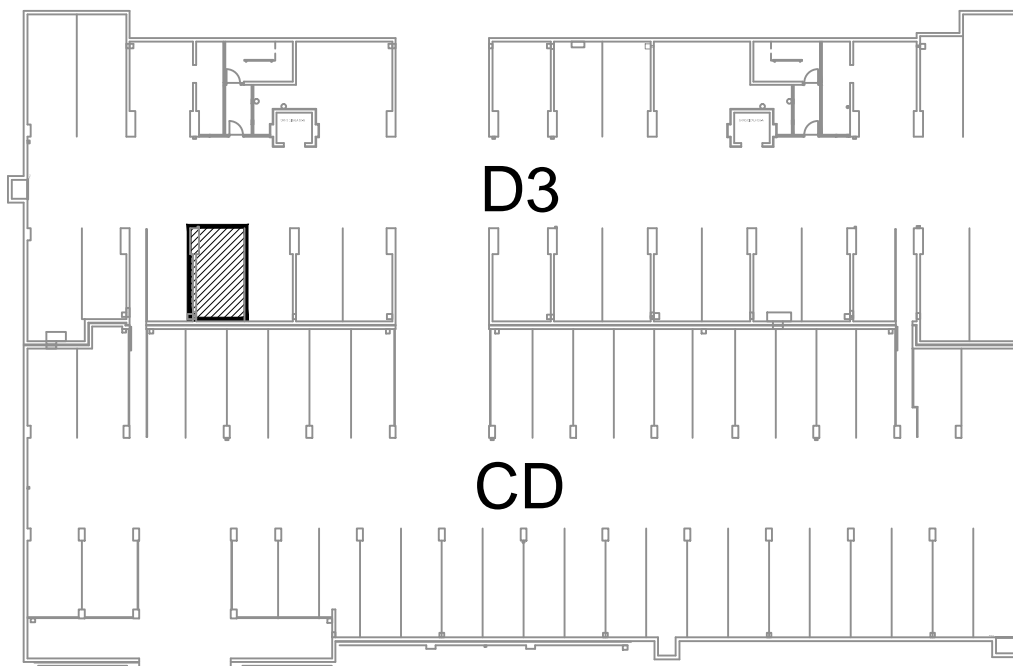

PODRUM -3

POLOŽAJ PARKIRALIŠTA U GARAŽI